

# CRE



## 14 Ellen Street SOUTH COOGEE NSW

4 2 2

Positioned in a family friendly enclave tucked away behind Bangor Park, this wide fronted double brick home is set on a deep level 455sqm and opens out to a huge sunny garden. Comfortable as is with a spacious single level layout, 'Braemar' offers a superb canvas for reinvention capitalising on its generous block and enormous potential. Be inspired by luxurious neighbouring properties and explore the scope to recreate with potential for a second level (STCA). Walk to schools, village shops and The Spot's cafe hub.

**View** : <https://www.coogee realestate.com.au/sale/nsw/eastern-suburbs/south-coogee/residential/house/5903013>

### Features Include

- 4 bedrooms, 3 with built-ins, oversized main bedroom
- Fluid living & dining rooms overlooking the gardens
- Timber-topped gas kitchen with a walk-in pantry
- 2 full bathrooms plus a separate internal laundry room



**James Giltinan**  
02 9665 3341



© Dimensions shown on plans are approximate values in L x W  
Colour symbols and area coding are subject to copyright  
Illustration by Raoul Isidro 04111 28950



Plans shown are for presentation purposes only and are not part of any legal document or title and are subject to errors, omissions, inaccuracies and they should not be used as sole and/or accurate reference for purchasing decisions. Interested parties should make their own enquiries using other sources supplied.

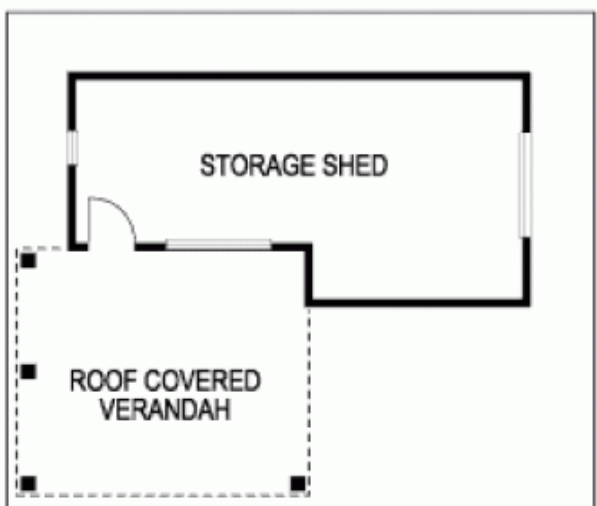

**14 Ellen Street RANDWICK**  
*"BRAEMAR"*