

# CRE



## 3 Eulalie Avenue Randwick NSW

3 1 2

One of only a handful of homes in a quiet cul-de-sac off Avoca Street, this wide-fronted 1930s semi bears all the hallmarks of its heritage with gracious proportions, soaring ornate ceilings and polished floorboards bringing a welcoming feel to the interiors. Spread over 252sqm and opening to a sunny north-facing courtyard, the three-bedroom home has been lovingly held for 27 years with a fluid layout from front to back ideal for family living with double parking a rare bonus in the heart of Randwick. In a peaceful spot with no through traffic just 350m to the village hub, this character-filled home features a huge lined attic with potential for a second level addition in line with the neighbouring property (STCA). With great schools all around, this quiet spot is within easy reach of Centennial Park and surf beaches.

**View :** <https://www.coogeerealestate.com.au/sale/nsw/eastern-suburbs/randwick/residential/house/6687645>



**Donna Burke**  
0418 213 210

+ Wide-fronted 1930 's semi on a sunny level block

<https://www.coogeerealestate.com.au>

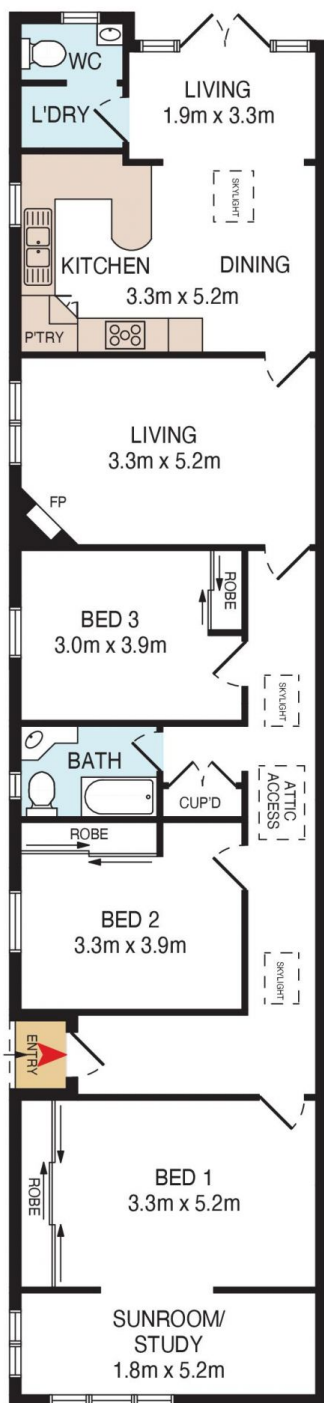

GROUND LEVEL

CRE

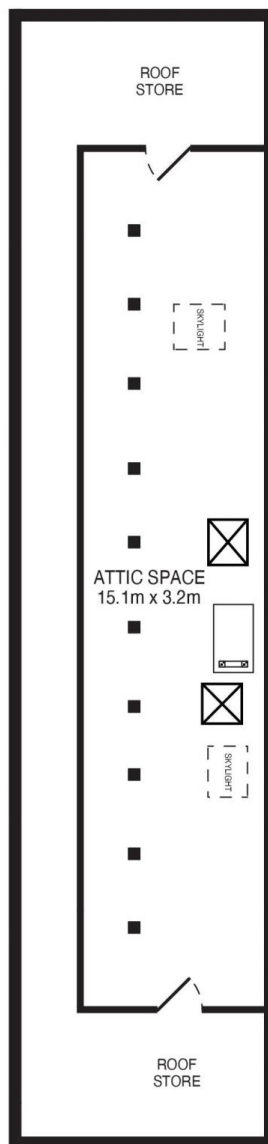

ATTIC

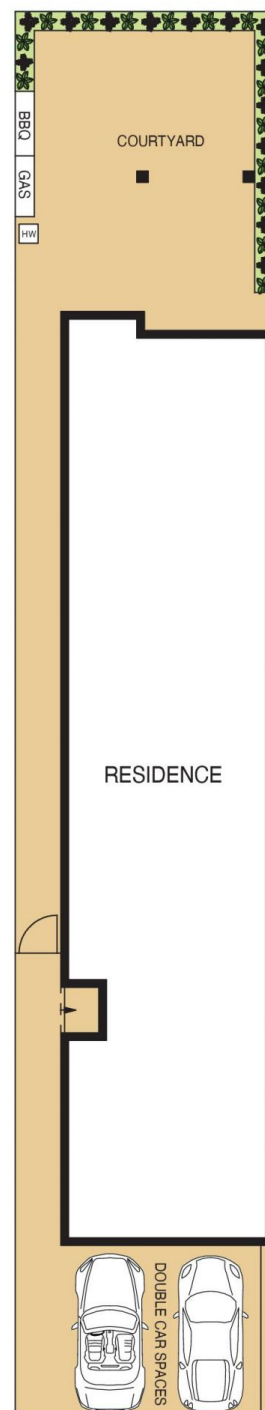

SITE PLAN



DISCLAIMER: THIS IS FOR ILLUSTRATIVE PURPOSES ONLY.  
ALL DIMENSIONS ARE APPROXIMATE AND IT DOES NOT  
CONSTITUTE PART OF ANY LEGAL DOCUMENTS

3 Eulalie Avenue

Randwick