

# CRE



## 82 Denison Street Bondi Junction NSW

3 2 2

Victorian grandeur meets contemporary comfort in this 6.1m fronted terrace on the edge of Bondi Junction's newly revived urban playground. Spread over three levels on a dual access block, the interiors of the three-bedroom home have been opened out to bring in the light and air with a spacious family friendly layout featuring a choice of living areas and invaluable double garaging at the rear. All three bedrooms are king sized, the main opening to a wide iron lace balcony and appointed with a luxurious ensuite and a dressing room or ideal nursery. Sweeping elevated views out over neighbouring parklands create a superb backdrop to the top floor retreat while a landscaped courtyard with a barbecue pergola promises a perfect setting for entertaining. Enjoy the best of parkside living and urban convenience, an easy 600m walk to Westfield and the station and 700m to the York Road gates to Centennial Park.

**Land Size** : 157 sqm  
**View** : <https://www.coogeerealestate.com.au/sale/nsw/eastern-suburbs/bondi-junction/residential/terrace/7932331>



**James Giltinan**  
02 9665 3341



**Donna Burke**  
02 9665 3341



SITE PLAN



FIRST FLOOR

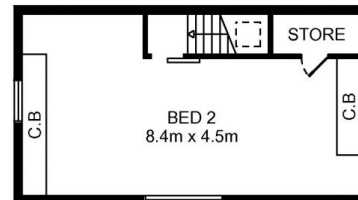

TOP FLOOR

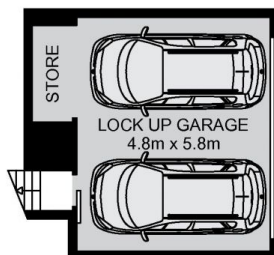

LOWER GROUND

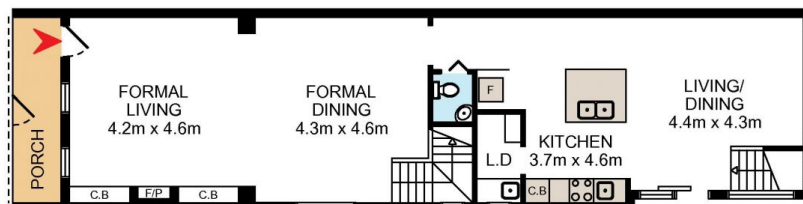

GROUND FLOOR



DISCLAIMER: THIS IS FOR ILLUSTRATIVE PURPOSES ONLY.  
ALL DIMENSIONS ARE APPROXIMATE AND IT DOES NOT  
CONSTITUTE PART OF ANY LEGAL DOCUMENTS.

82 Denison Street

Bondi Junction